

- Legend**
- 1800mm high close boarded timber fence
 - 1200mm high timber post and rail fence (3 No. Rails)
 - Buff coloured concrete paving slabs
 - Permeable concrete pavior blocks
 - Gravel
 - Grass
 - Existing Hawthorn Hedge (retained)
 - Existing Hawthorn Hedge (removed)

Dashed Purple line indicates line of existing established public right of way (Q2.2) from NYCC records (Search Ref: 48-19200284-0B)

New Hibernaculum constructed in accordance with wildlife trust guidance

Garden is to be landscaped in accordance with Landscaping scheme to approval

Adjusted footpath Minimum width 1.5m to full length within site

Air Source Heat Pump on concrete base

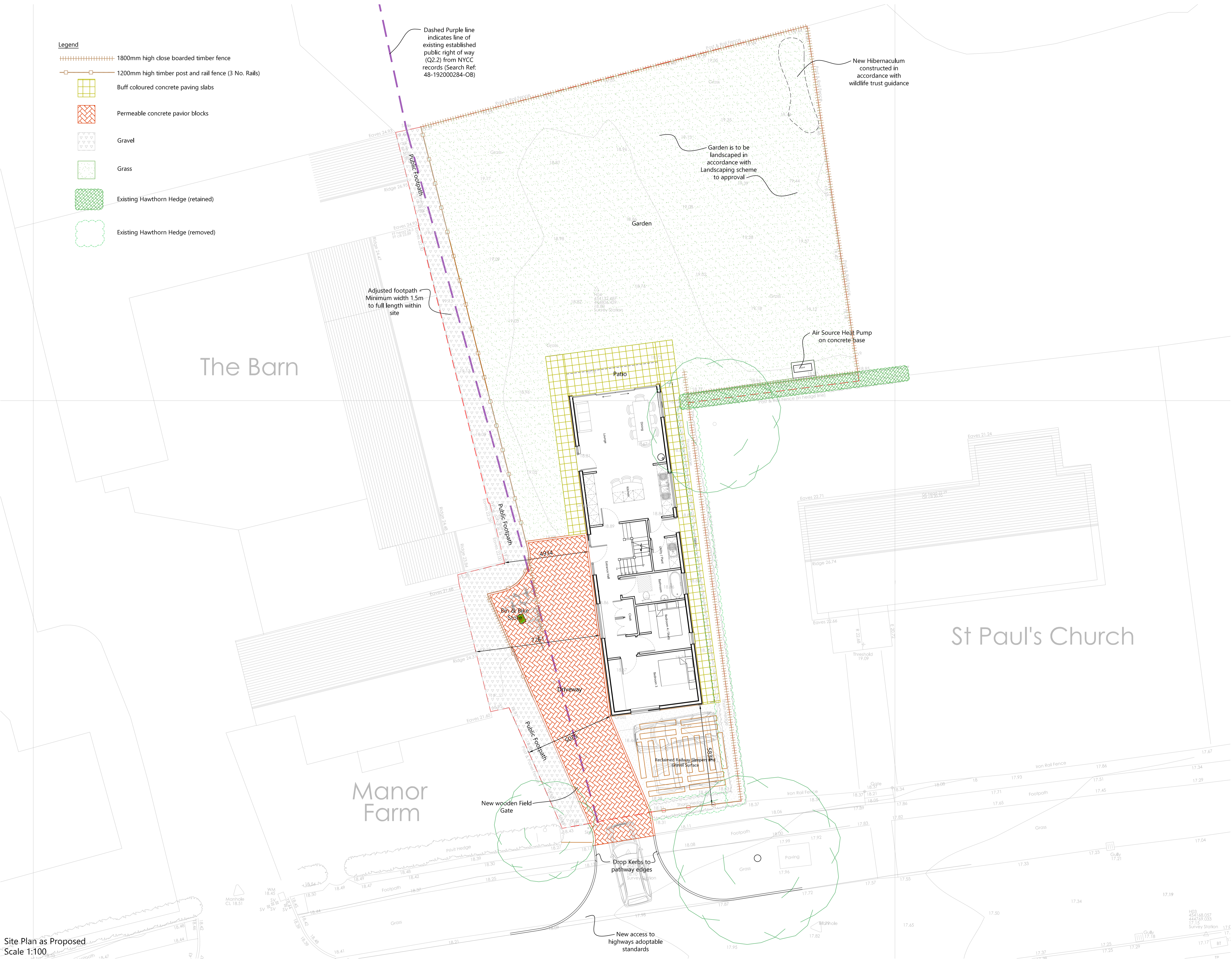

Notes:
 The contractor is responsible for checking dimensions, any discrepancies to be determined by the architects before proceeding with the works.
 No dimensions to be scaled from drawing, figured dimensions to be worked to in all cases.
 All materials used and work undertaken to be in accordance with relevant British Standard Codes Of Practice and the Building Regulations with subsequent amendments.
 © The contents of this drawing are the property of Mike Fining Chartered Architects and must not be reproduced without their expressed written consent.

AMENDED DRAWING

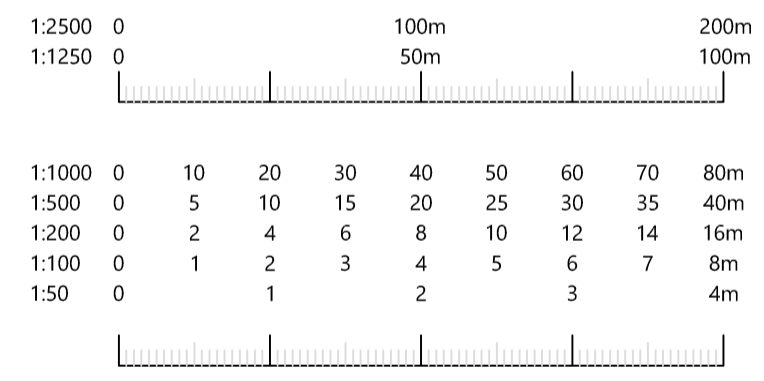

Revision	Note	Date
G	Revised following highway officer's comments	01/03/21
F	Revised following highway officer's comments	15/12/20
E	Client Comments incorporated	21/09/20
D	Planner and Client Comments incorporated	11/09/20
C	House Position Adjusted	20/02/20
B	Highway Access Shown	15/01/20
A	Client Comments incorporated	18/12/19

Project: Land Adj. Church, Main St., Colton, Tadcaster, LS24 8EP
Title: Site Plan as Proposed
Client: Mr Grant Henderson
Scale: 1:100 @ A1
Date: 11/12/19
Drawn By: DJM
Drawing Number: 999.005
Revision: G



SAVE DANE LODGE
 22 MAIN STREET, NETHER POPPLETON,
 YORK, YO26 6HS
 T: 01904 788098
 Emike@architectsyork.com
 www.architectsyork.com

Site Plan as Proposed
 Scale 1:100